

TEMPLE WATERFRONT, STROOD

OVERVIEW

CLIENT
Morgan Timber

SECTORS
Residential

LOCATION
Strood, Medway

PLANNING AUTHORITY
Medway Council

HIGHWAY AUTHORITY
Medway Council

PROJECT TEAM
Hester Architects Ltd
DKI Property
Implementation of Management
Solutions Ltd

PROJECT MANAGER
Stephen Kemp

PROJECT DIRECTOR
Daniel Ekstrand

RELATED PROJECTS



Oakhill House, Hildenborough

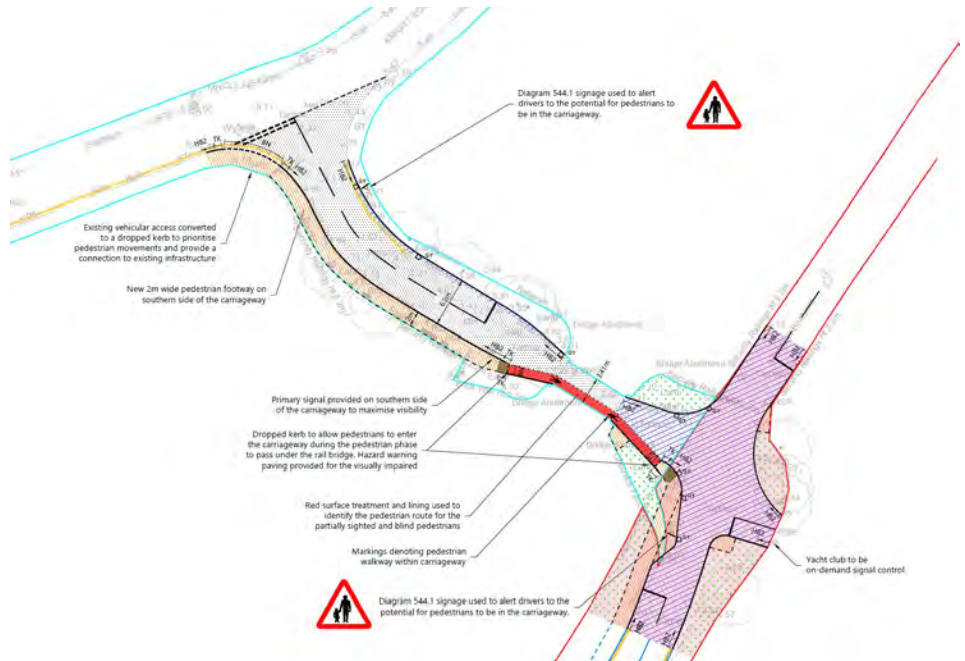

PROJECT

We were appointed to support Morgan Timber with a planning application to redevelop their existing timber yard in Strood, Medway. The scheme sought outline planning permission for up to 168 dwellings with primary access taken via the existing Redrow scheme on the western boundary and a secondary access provided onto Knight Road via the existing railway one-way working underbridge.

APPROACH

We sought pre-application advice from Medway's Highway Authority and agreed the scope and extent of evidence required to support the planning application. A Transport Assessment and a Framework Travel Plan were prepared and submitted as part of the planning application.

Following submission of the application the Highway Authority raised new concerns in relation to the proposed secondary access onto Knight Road. Specifically concerns were raised regarding the inclusivity of the proposed arrangement and the deliverability of a signal-solution at this location.

Following considerable further engagement with the Highway Authority we prepared detailed design drawings providing assurance that the scheme could be delivered and identifying the potential impact of the scheme, noting the existing land use, and the mix of HGVs and pedestrians from the neighbouring Redrow scheme in the current arrangement. This resulted in the removal of the Highway Authority's holding objection, as they realised that our scheme would provide a net benefit compared to the existing situation.

OUTCOME

The application was granted planning permission subject to conditions.

