



ARCHES 309-310, WYNDHAM ROAD

OVERVIEW

CLIENT

The Arch Company

SECTORS

Commercial
Warehouse & Distribution

LOCATION

Camberwell,
Southwark

PLANNING AUTHORITY

London Borough of Southwark

HIGHWAY AUTHORITY

London Borough of Southwark

PROJECT TEAM

Turley
Hollis

PROJECT MANAGER

Jack Massey

PROJECT DIRECTOR

Daniel Ekstrand

RELATED PROJECTS

57-58 Royal Mild St, Shadwell

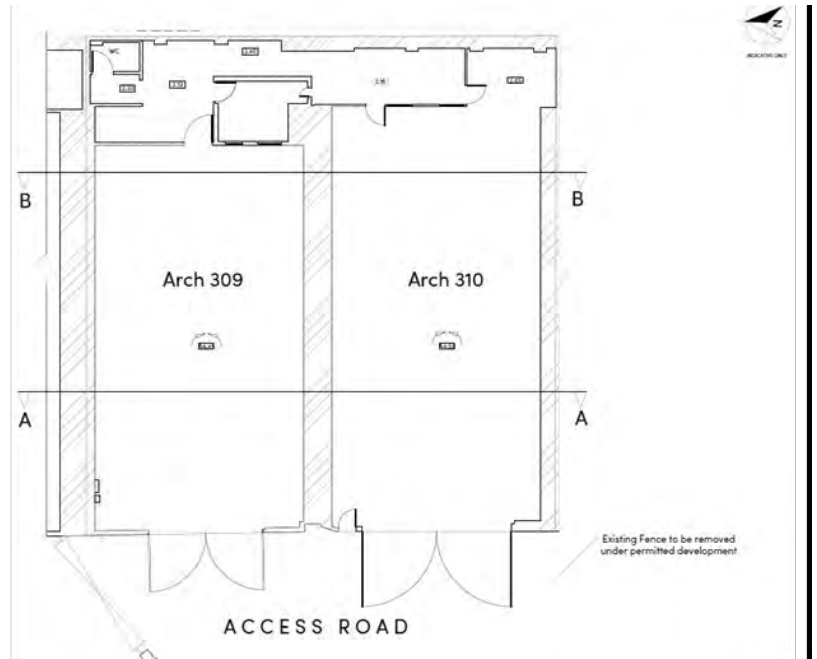
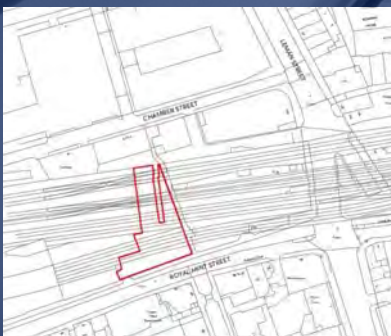

PROJECT

We were appointed by The Arch Company to provide a Transport Statement in relation to the proposed change of use application for Arches 309-310, Wyndham Road, Camberwell, SE5 0UN.

The site comprises of two vacant arches with a total Gross Internal Area of 235m². The development sought to seek the change of use of two railway arches to flexible uses within Use Class E(g)(iii) and/or B8.

APPROACH

A Transport Statement was prepared in support of the planning application, demonstrating the proposals compliance with the relevant transport policies on parking and sustainability.

It was also illustrated that the proposals would not have a detrimental impact on the local highway network in terms of operational capacity, highways safety, nor through additional on-street parking.

OUTCOME

The planning application was submitted to Southwark Council in November of 2023. Following further discussions with Southwark Council, we were able to agree a suitable approach towards cycle parking and servicing of the site.

The planning application was subsequently granted permission in May 2024.

